



MEETING & EVENT SPACES

Theatre

Located between the Eisenhower Rooms and the Lower Lobby, the Theatre has seating for 300 guests. Comfortable padded seats provide a spectacular view of a stage perfect for performances and a giant screen for movies or presentations.

The theatre regularly hosts complimentary movies, history presentations and other entertainment for guests, but it's also an ideal spot for lectures, audio-visual presentations on informational sessions with large groups. It's decorated with vintage posters of actors and actresses, and the back of the room provides ample space for tables, displays or refreshments.

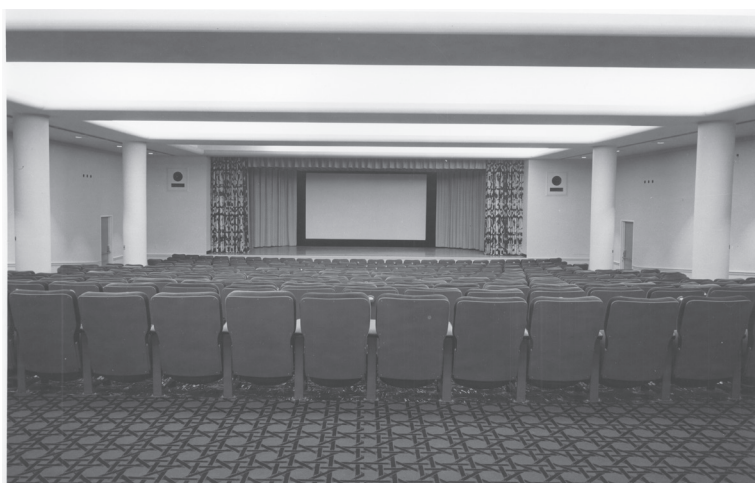
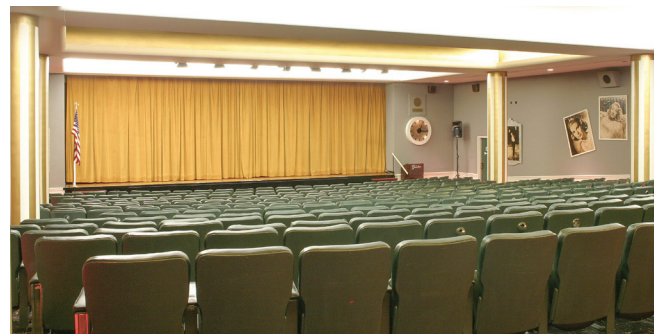

The Theatre - circa 1970s

Theatre FLOORPLAN

The
Greenbrier
AMERICA'S RESORT

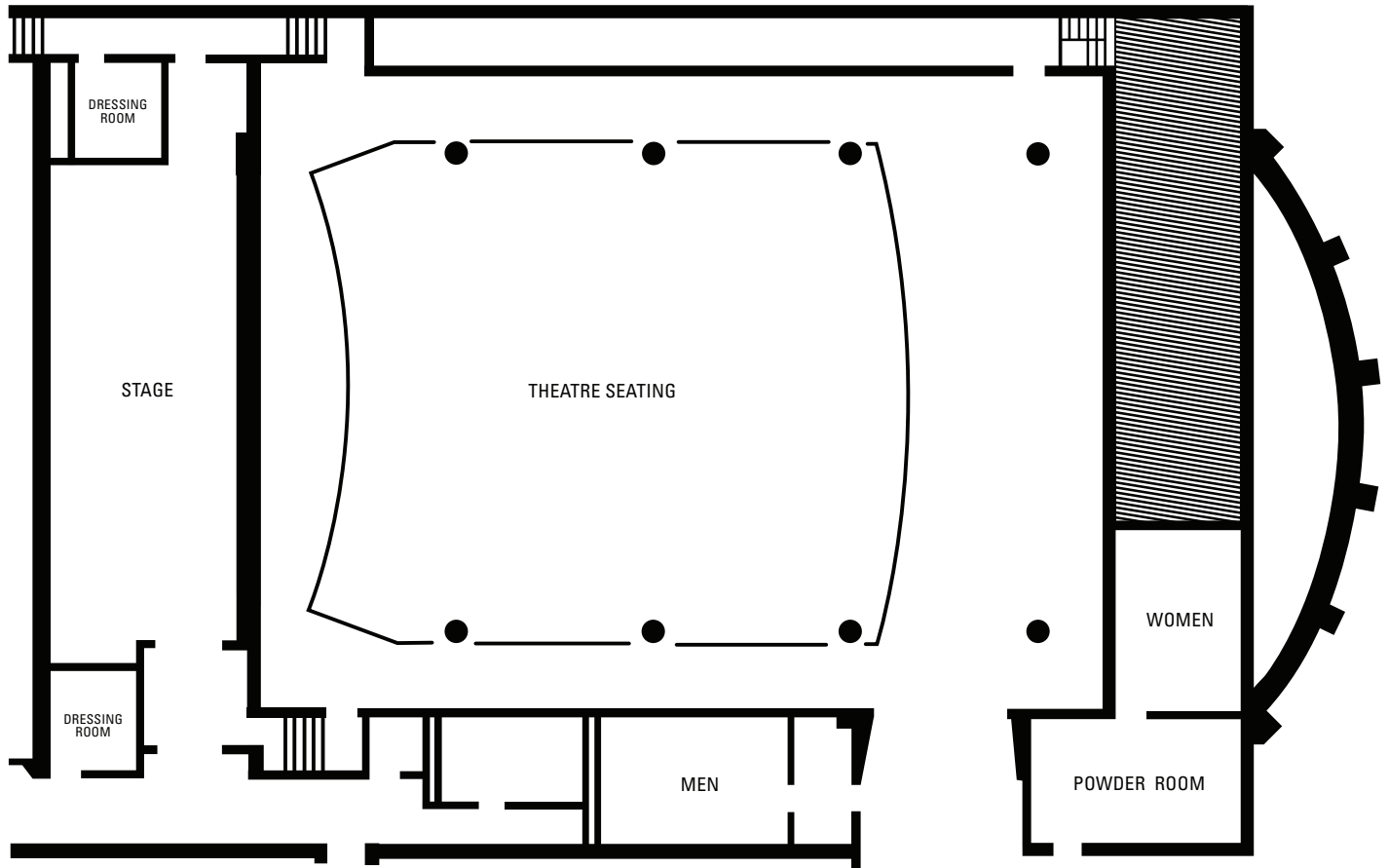

ROOM SPECIFICATIONS

4,256 square feet | 56' x 76' x 16'

ROOM CAPABILITIES

Type	Number of Guests
Theatre	300

