



MEETING & EVENT SPACES

Crystal Room

Located adjacent to the Upper Lobby, the Crystal Ballroom is a magnificent space for meetings and events. Once an auditorium used for entertaining patients at Ashford General Hospital with a variety of programs,

Dorothy Draper and Carleton Varney eventually transformed the room into the elegant space that guests are eager to occupy today. The first interior space that Varney designed at The Greenbrier, the ballroom features intricate details such as gilded sconces with musical instruments, crystal chandeliers and a medallion-patterned carpet. It's an ideal spot for meetings, receptions or elegant dinners.



Governor's Conference - Crystal Room circa 1950

Crystal Room FLOORPLAN

The
Greenbrier
AMERICA'S RESORT

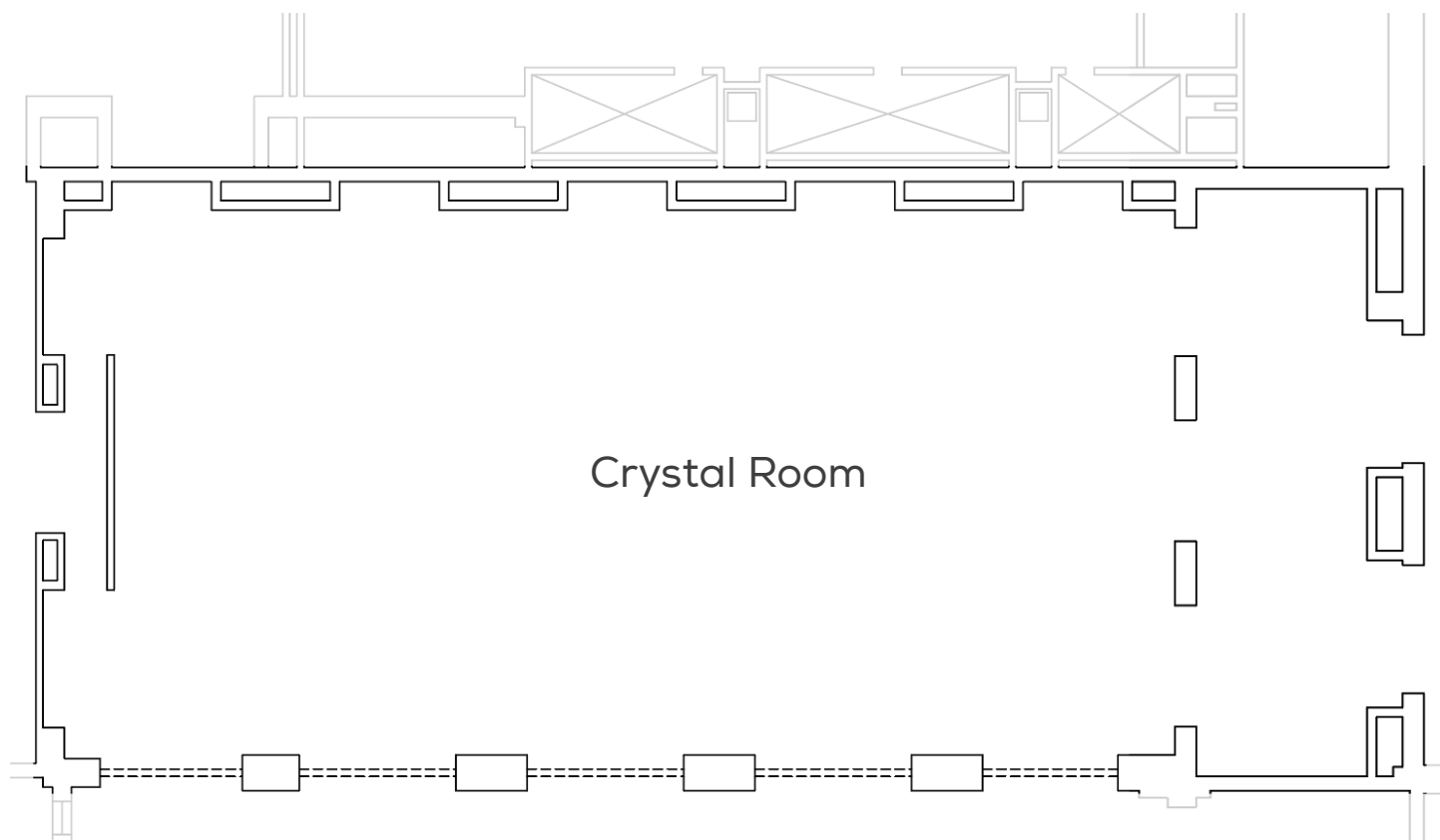

ROOM SPECIFICATIONS

3,040 square feet | L x W x H: 80' x 38' x 19'6"

ROOM CAPABILITIES

Type	Number of Guests
Theatre	250
Banquet	160
Conference	500
Hollow	76
Classroom	150
U-Shaped	70
Cocktail	200

