



The
Greenbrier[®]
AMERICA'S RESORT

MEETING PLANNER GUIDE



The tradition of “America’s Resort™” dates back to 1778, when guests first came to White Sulphur Springs to “take the waters” of the iconic mineral springs that run through the property. The 11,000-acre estate features 710 Signature Resort Rooms, Classic and Historic Suites, Legacy Cottages and Estate Homes.

More than 55 indoor and outdoor activities are available to guests, providing entertainment for all ages and interests in every season. Some of the most popular adventures include fishing, horseback riding, falconry, off-road driving, golf and indoor and outdoor tennis. The full-service, 40,000-square-foot mineral spa is widely recognized as one of the most luxurious in the world.

The Greenbrier Retail Collection is comprised of 35 boutiques and shops, including seven artisan shops with handmade crafts from local artists.

The Greenbrier Dining Collection includes 20 restaurants, cafes and lounges, serving award-winning cuisine prepared by internationally recognized chefs. The legendary Main Dining Room has been serving breakfast and dinner to guests since 1913.

The Casino Club at The Greenbrier is America’s only private casino, featuring 320 state-of-the-art slot machines, 35 table games and sports wagering at the FanDuel Sportsbook - in a smoke-free, upscale environment.

A newly renovated Conference Center provides the perfect location to stage meetings of all sizes in a facility that matches the legacy of America’s Resort. State-of-the-art technology is combined with unique Dorothy Draper design to create a functional and memorable setting for work to be completed.

Golf at The Greenbrier dates back more than a century. The Old White Course, a CB Macdonald masterpiece, debuted in 1914 and was an annual stop on the PGA TOUR from 2010 through 2019. A newly redesigned Meadows Course combines unparalleled mountain views with signature stacked sod bunkers. The Greenbrier Course, which hosted both the Ryder Cup (1979) and Solheim Cup (1994), is currently operating as a nine-hole course, and The Ashford Short Course gives golfers the opportunity to work on their short games on a 9-hole, par-3 walking course.

Major events at The Greenbrier each year include The Greenbrier Champions Tennis Classic (fall) and The Greenbrier Concours d’Elegance (spring). The Greenbrier has also hosted professional sports organizations such as the PGA TOUR, the National Football League, World TeamTennis, and world-class equestrian events.





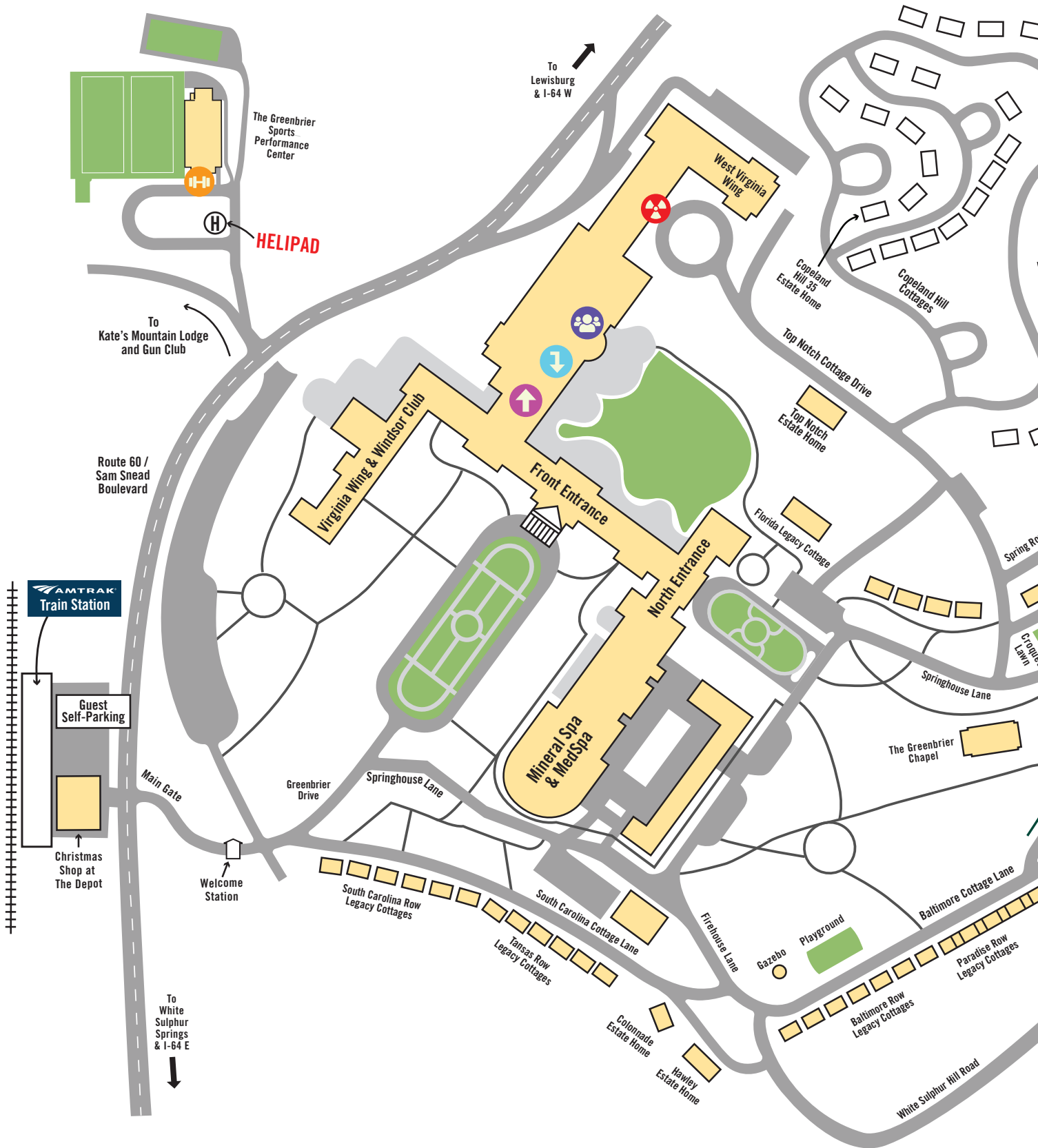





Estate Map



-  Conference Center
-  Lower Level
-  Upper Level
-  Sports Performance Center
-  The Bunker



	ROAD
	ONE WAY
	WALKING PATH & TRAIL
	RAILROAD TRACKS
	BRIDGE
	DINING
	SPRINGHOUSE



1 Lower Level

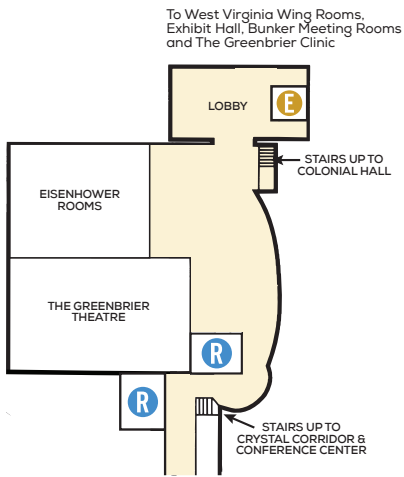

Lower Level	Sq. Ft.	Dimensions L x W x H	Capacity (Theater)
Eisenhower A	1,800	30' x 60' x 11' 6"	150
Eisenhower B	1,800	30' x 60' x 11' 6"	150
Eisenhower C	1,800	30' x 60' x 11' 6"	150
Eisenhower Room	5,400	90' x 60' x 11' 6"	450
Eisenhower Room A & B	3,600	60' x 60' x 11' 6"	320
Eisenhower Room B & C	3,600	60' x 60' x 11' 6"	320
Rhododendron Terrace	5,720	55' 1" x 104' 8"	200
The Greenbrier Theatre	4,256	56' x 76' x 16'	300



↑ Upper Level



Upper Level	Sq. Ft.	Dimensions L x W x H	Capacity (Theater)
Cameo Ballroom	6,240	79' 6" x 78' 4" x 15' 9"	300
Chesapeake Bay	1,262	47' x 27' x 12' 5"	70
Chesapeake Terrace	1,827	29' x 63'	-
Chesapeake Room	5,472	72' x 76' x 22'	549
Colonial Hall	16,128	112' x 144' x 22'	1,600
Colonial Lounge	1,632	24' x 68' x 25'	-
Colonial Terrace	13,420	110' x 122'	-
Crystal Room	3,040	80' x 38' x 19' 6"	274
Spring Room	544	17' x 32' x 15' 9"	50
Washington Room	390	30' x 13' x 13'	35



Conference Center

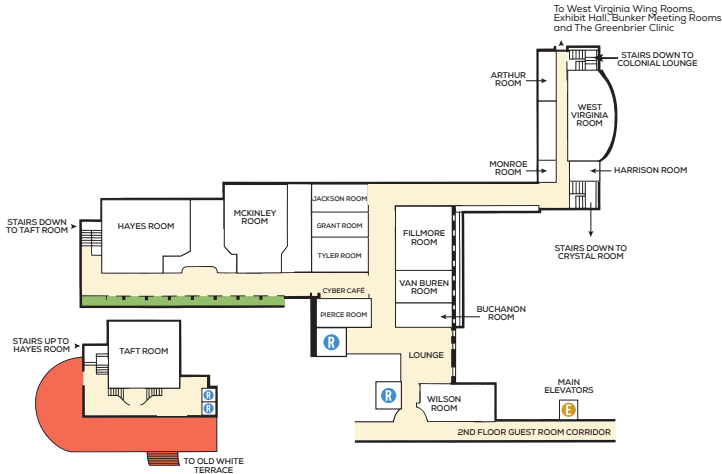

Conference Center	Sq. Ft.	Dimensions L x W x H	Capacity (Theater)
Arthur Room	250	25' x 10' x 9'	24
Buchanan Room	377	29' x 13' x 8' 6"	25
Fillmore & Van Buren Rooms	1,568	32' x 49' x 8' 6"	70
Fillmore Room	1,152	32' x 36' x 8' 6"	50
Grant Room	448	32' x 14' x 8' 6"	25
Harrison Room	160	16' x 10' x 9'	16
Hayes Room	1,470	49' x 30' x 14'	90
Jackson Room	416	32' x 12' x 8' 6"	25
McKinley Room	1,330	35' x 38' x 14'	70
Monroe Room	120	10' x 12' x 8' 6"	12
Pierce Room	512	32' x 16' x 8' 6"	25
Taft Foyer	968	8' 7" x 75' 1" x 9' 5"	n/a
Taft Room	1,836	49' x 36' x 14'	160
Tyler Room	601	32' x 19' x 8' 6"	30
Van Buren Room	416	32' x 13' x 8' 6"	20
West Virginia Room	1,269	47' x 27' x 9'	90
Wilson Room	570	30' x 19' x 8' 6"	25

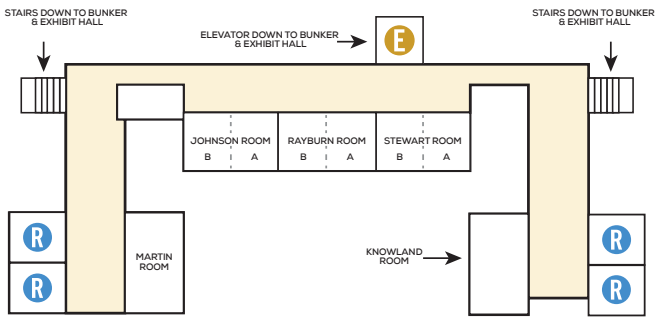

The Bunker	Sq. Ft.	Dimensions L x W x H	Capacity (Theater)
Johnson Room A	360	20' 3" x 17' 8"	32
Johnson Room A & B	660	20' 3" x 33'	70
Johnson Room B	300	20' 3" x 15'	32
Martin Room	725	20' 6" x 35' 4"	72
Knowland Room	725	20' 6" x 35' 4"	72
Rayburn Room A	680	34' 7" x 20' 3"	32
Rayburn Room A & B	1,380	69' 4" x 20' 3"	72
Rayburn Room B	680	34' 7" x 20' 3"	32
Stewart Room A	300	20' 3" x 15'	32
Stewart Room A & B	660	20' 3" x 33'	70
Stewart Room B	360	20' 3" x 17' 8"	32



Stewart Room B



Martin Room



Knowland Room

Sports Performance Center

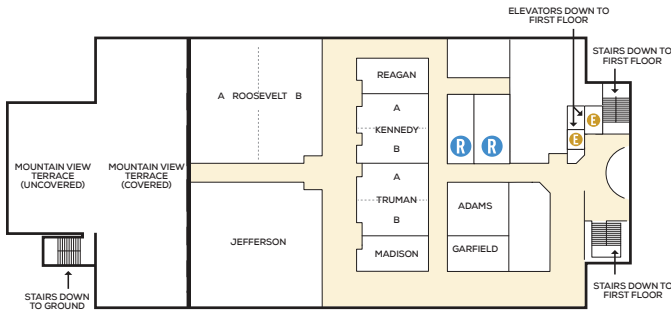

Sports Performance Center	Sq. Ft.	Dimensions L x W x H	Capacity (Theater)
Adams	672	27' x 24' x 12'	75
Garfield	448	27' x 16' x 12'	50
Jefferson	3,190	58' x 56' x 15'	350
Kennedy	980	31' x 31' x 12'	100
Kennedy A	490	31' x 15.5' x 12'	50
Kennedy B	490	31' x 15.5' x 12'	50
Madison	528	31' x 16' x 12'	50
Mountain View Terrace	7,221	-	-
Mountain View Terrace (Covered)	5,038	119' x 42' x 15'	-
Mountain View Terrace (Uncovered)	2,183	59' x 37' x 15'	-
Reagan	495	31' x 15' x 12'	45
Roosevelt	3,190	57' x 59' x 15'	350
Roosevelt A	1,595	28.5' x 28' x 15'	175
Roosevelt B	1,595	28.5' x 28' x 15'	175
Truman	1,056	31' x 15' x 12'	115
Truman A	528	31' x 15' x 12'	55
Truman B	528	31' x 15' x 12'	55



Additional Areas

Additional Areas	Sq. Ft.	Dimensions L x W x H	Capacity (Theater)
Champions Room	1,827	29' x 63' x 10' 4"	200
Culinary Arts Center	4,900	70' x 70' x 8' 6"	160
Exhibit Center	16,554	89' x 186' x 11' 6"	N/A
Golf Academy	5,696	89' x 64' x 10' 5"	100
Governor's Hall	4,056	78' x 52' x 9' 6"	326
Gun Club	660	33' x 20' x 9'	30
Howard's Creek Lodge	1,568	28' x 56' x 11' 6"	125
Kate's Mountain Lodge	2,883	39' 6" x 73' x 13'	90
Mountaineer Room	1,161	43' x 27' x 8' 6"	97
Outdoor Pool	-	-	-
Prime 44 Vineyard	616	22' x 28' x 9'	40
Prime 44 Vineyard Lounge	450	30' x 15' x 9'	-



Getting to The Greenbrier

HAS NEVER BEEN EASIER

Located in the Allegheny Mountains of West Virginia, The Greenbrier is conveniently situated within a 500-mile radius of most of the East Coast, including New York, Cleveland, Indianapolis and Atlanta. America's Resort™ is less than a 5-hour drive from Charlotte, Washington, D.C., Baltimore and Pittsburgh.

SCENIC DRIVE

From Interstate 64, The Greenbrier is located less than five miles off of Exit 175 (East) or 181 (West) on Route 60.

COMMERCIAL FLIGHTS

Daily direct flights are available via Contour Airlines via American Airlines to Greenbrier Valley Airport (LWB), 15 minutes from The Greenbrier, from Charlotte-Douglas International Airport (CLT). Other major airports convenient to The Greenbrier include Roanoke, Va. (ROA, 75 minutes), Charleston, W.Va. (CRW, 85 minutes) and Beckley, W.Va. (BKW, 50 minutes), with service provided by major carriers and shuttle service to The Greenbrier available.

HISTORIC TRAIN SERVICE ON AMTRAK

Amtrak's Cardinal Route travels from New York's Penn Station to Chicago's Union Station three times per week with a stop in White Sulphur Springs, directly across the street from The Greenbrier's main entrance. To book, visit Amtrak.com.



For more information or to discuss the needs of your group, please contact:

Greg Furlong

VP of Sales & Event Services

Office – (304) 536-4903 Mobile – (304) 661-5166

greg_furlong@greenbrier.com